



National Health and Nutrition Examination Survey

Examination Consent



U.S. DEPARTMENT OF HEALTH AND HUMAN SERVICES
Centers for Disease Control and Prevention
National Center for Health Statistics

This booklet contains facts for you about the
National Health and Nutrition Examination Survey

What is the National Health and Nutrition Examination Survey (NHANES)?

NHANES is a survey conducted by the National Center for Health Statistics (NCHS). NCHS is a part of the Centers for Disease Control and Prevention, U.S. Department of Health and Human Services.

We select a sample of people in towns and cities across the country to be part of the survey. Each year of the survey, we will examine about 5,000 people in 15 different sites. NHANES programs began in the early 1960s. The current survey began in 1999 and will now be an ongoing program. More than 130,000 persons have been part of past NHANES programs.



We have designed the study to learn about the health and diet of people in the United States.

Our survey is unique. It combines a home interview with health tests, which we do in mobile units. These special exam centers travel the country with a highly trained medical team. Our team conducts an exam that looks at special health topics. They use the most up-to-date methods and equipment for medical and dental exams, and other lab tests.

We will use the data gathered in this survey to assess the number of people with certain health problems — for example, diabetes and high blood pressure. We will look at diet and other habits that affect health, such as smoking and exercise. NHANES data will describe the health and nutrition of people of all ages. It will also help design health programs and services, and expand our knowledge about the health of people in the United States.

Why were you selected?

We picked you and your household in a carefully designed sample of people living in the United States. We cannot choose someone in your place because no one has the same health profile as you. Having you as part of our survey will help make our information complete. We will add the data from your interview and exam to that from all others who join in this study. That data will give us a big picture of our nation's health.

You may choose to take part in the survey and you may permit your child to join in. That is your choice. No penalties or loss of benefits will come from refusing to take part. You may refuse any part of the exam and are free to drop out anytime. Also, during the interviews you may choose not to answer any question.

What do you gain by taking part in the survey?

- Free health test results, perhaps some of major value to you
- The chance to help learn more about the health of the nation
- A cash payment to thank you for your time and effort

Are the data we collect confidential?

We respect your privacy. Public laws keep all information you give confidential.

We will hold all data we collect in the strictest confidence. We gather and protect all data in keeping with the requirements of Federal laws: the Public Health Service Act (42 USC 242k) authorizes collection and Section 308(d) of that law (42 USC 242m) and the Privacy Act of 1974 (5 USC 552A) prohibit us from giving out information that identifies you or your family without your consent. This means that we cannot give out any fact about you, even if a court of law asks for it. However, if we find signs of child abuse during an exam, we will report it to the local department of social services or appropriate law enforcement agency.

We will keep all survey data safe and secure. Sometimes certain collaborators, such as the U.S. Department of Agriculture and the National Center for Environmental Health, assist us in data preparation, analysis, and research. When they do, the information is handled with strict requirements to protect your confidentiality as guaranteed by NCHS. When we allow other collaborators and researchers to use survey data, we protect your privacy. We assign code numbers in place of names and never reveal other facts that could directly identify you.



What about the exam?

Our interviewer will ask you to make an appointment for the exam at the mobile exam center. Our medical team will collect health data by examining you, doing lab testing, and asking questions about your health. No internal exam is included. No drug testing will be done. We may ask you to prepare for the exam by fasting for a short time. The exam may take from 2-1/2 to 4 hours for those 12 and older and 1-3 hours for younger children. The time depends on the age of the person examined, since some procedures are done only for certain ages. (For a full list of procedures, see page 5.)

Reports of Exam Findings

The survey exam does not replace regular health care. However, you will get some exam results at the exam site. If the exam reveals urgent health problems, we will notify you at once and refer you for treatment. If some urgent problem is found through your lab tests, immediately we will send that information in a letter to your home address. If you wish, we



will mail the routine findings report to you about 12-16 weeks after the exam. In general, we give results only to the person examined or to the parents/guardians of children. Some results, such as sexually transmitted disease (STD) tests, are given in special ways explained below. We will not give you results from some tests because they will be used only for research. NHANES does not cover the cost of any health care you may decide to seek after the exam.

Safety of Tests

We chose the tests and measurements because they are safe. As in any other exam like this, some procedures may give slight discomfort. Examples are collecting a blood sample or doing the dental exam. For the blood sample, a person will have a small amount of blood drawn from a vein in his/her arm with a needle. We will not ask you to have any test or procedure that is wrong for you because of a health problem or condition.

We will give bone density tests that involve low-dosage x-rays to persons 8 years old and older. Radiation exposure during this test is equal to a cross-country airline flight or a few days of natural background radiation. But because the bone density scan involves x-rays, no one who is pregnant should get this exam. We will obtain information about periods from girls and women, and those who have started their periods will have a urine pregnancy test. Those with a positive test will not have the bone density scan. Also, pregnant women and girls will not have fitness testing if they are in their second or third trimester. We report positive test results only to the person tested if she is 14 years old or older. If a girl is under 14 and has a positive pregnancy test, we will inform both her and her parent/guardian.

Private Health Interview

At the exam center, all persons who are 12-59 years old will be asked some personal questions in complete privacy. You will be alone in a room. The questions will be on a computer screen. You respond by touching an answer on the screen. Your answers are completely confidential. We ask these questions because some behaviors relate to people's health. Persons are asked about sexual experience and the use of illegal drugs.



Also, our staff will ask persons who are 8-39 years old some questions about their feelings and behavior. If you are 15 or younger, a staff member will call your home after your exam to ask your mother (or other caretaker) these same questions about you.

If you are the parent/guardian of a child age 8-15 who is seen in NHANES, you will receive a phone call within a few weeks after the exam. Our staff will ask you questions about your child's feelings and how he or she is behaving at home and school. The interview will take about 1/2 hour. Your permission for your child's exam also gives consent for this phone call.

Tests for Reproductive Health and Sexually Transmitted Disease (STD)

Females aged 14-59 years will be asked to do private, self-administered, vaginal swabs. Depending on age, these swabs will be tested for bacterial vaginosis and two sexually transmitted germs: *Trichomonas*, and human papillomavirus (HPV). In addition, all persons 14-49 years will have their blood and urine tested for STDs. Depending on age, tests will be for some or all of these diseases: chlamydia, gonorrhea, herpes, syphilis, and HIV. We will not put these results in writing, but you can get reproductive health and STD test results a few weeks after the exam. Before leaving the exam center, you will receive a toll-free number, a password, and the dates to call for

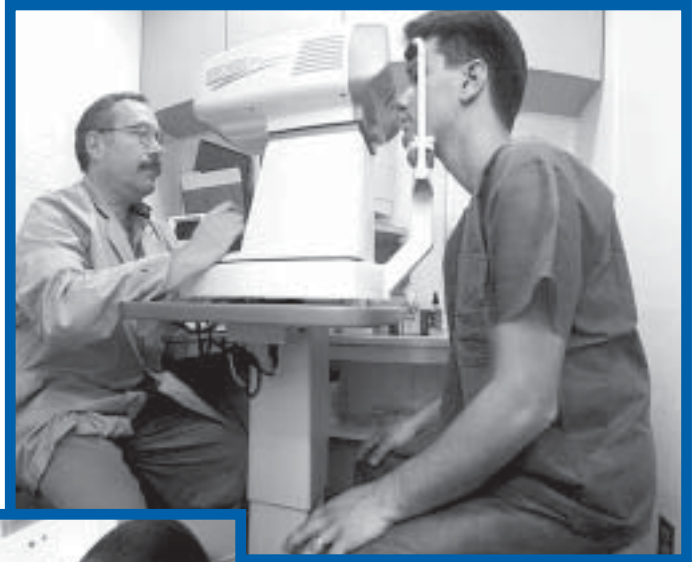

your results. Only you will get your test results by calling in and telling us your password. Parents will not be informed of their child's STD test results. If your test results show that you have a current health problem, we will talk with you about the results and tell you how to seek treatment. We will keep all STD/HIV test results completely private, just like all other test results. If you do not want to be tested, you can tell a staff member.

Digital photographs of your skin

Health technicians will use a digital camera to take four photos, or images, of the skin of adults. No images will be taken of the face. We will only take pictures of the back, arms, hands, and legs. We will send images to a skin doctor who will look for two skin conditions, psoriasis and hand dermatitis. If a skin condition that needs follow-up is seen, we will notify you by mail. However, some serious problems like skin cancer may not be visible in photos. Better ways of finding skin conditions in images may be developed in the future, and your images may be looked at again. We will not report results of future readings to you.



The NHANES Exam

Health Measurements

- * Doctor's exam - all ages
- * Blood pressure - ages 8 years and older
- * Body fat - ages 8 years and older
- * Bone density - ages 8 years and older
- * Oral health exam by a dentist - ages 2 years and older
- * Vision test - ages 12 years and older
- * Hearing test - ages 20-69 years
- * Fitness test - ages 12-49 years
- * Height, weight, and other body measures - all ages
- * Balance - ages 40 years and older
- * Leg circulation & sensation - ages 40 years and older
- * Skin conditions (hand dermatitis and psoriasis) ages 20-59 years

Lab Tests on Urine: (6 years and older)

- Kidney function tests - ages 6 and older
- *** Sexually transmitted disease (STD)
 - Chlamydia and gonorrhea - ages 14-39
 - Human immunodeficiency virus (HIV) - ages 18-49 (only if no blood is drawn)
- ** Exposure to environmental chemicals - selected persons ages 6 and older
- ** Pregnancy test - females 12-59 and girls 8-11 who have periods
 - * - ages 13 and under
 - *** - ages 14 and over

Lab Tests on Blood: (1 year and older)

- * Anemia - all ages
- * Cholesterol - ages 3 and older
- * Glucose measures - ages 12 and older
- Markers of immunization status - for ages 6-49
- ** Infectious diseases - ages 2 and older
- * Kidney function tests - ages 12 and older
- * Lead - all ages
- ** Cadmium - all ages
- ** Mercury - ages 1-5 and females ages 16-49
- * Liver function tests - ages 12 and older
- Nutrition status - all ages
- * Hormone tests - ages 6 and older
- * Prostate Specific Antigen (PSA) - males ages 40 and older

Lab Tests on Blood: (1 year and older) ... continued

- Sexually transmitted diseases (STD)
 - *** Herpes type 2 - ages 14-49
 - *** Syphilis and human immunodeficiency virus (HIV) - ages 18-49
 - Human papillomavirus (HPV) antibody ages 14-59
- ** Exposure to environmental chemicals - selected persons ages 6 and older

Lab Tests on Water

- ** Environmental chemicals - selected persons ages 20-59 years

Other Lab Tests

- *** Vaginal swabs (self-administered) - females ages 14-59 years
 - Bacterial Vaginosis and *Trichomonas* - ages 14-49 years
 - Human papillomavirus (HPV) - ages 14-59
- Nasal swab - ages 1 year and older
- Test for an antibiotic-resistant germ

Private Health Interviews

- Health status - all ages (parent answers for ages 11 years and younger)
- ** Mental health - ages 8-39 years
- Questions about drug and alcohol use - ages 12 and older (No drug testing will be done)
- Nutrition - all ages
- Physical activity - ages 12-15 years
- Reproductive health - females ages 12 years and older
- Questions about sexual experience - ages 14-59 years
- Tobacco use - ages 12 years and older
- Oral health - ages 16 years and older

- * Results reported to you or to your child and you
- ** Results reported only if positive (or abnormal)
- *** Results reported only to person tested

After your visit to the NHANES exam center:

Persons asked about the foods they eat will receive a phone call 3-10 days after their exam for a similar interview. In addition, a food questionnaire will be mailed to your home. Persons two years old and older are asked to complete this questionnaire and return it to our office in a prepaid envelope provided. Parents or guardians will answer for children 2-5 years and assist children 6-11. The questions will take 20-30 minutes to answer.

Persons six years old and older will be asked to wear a physical activity monitor. Exam staff will give you the monitor at the exam. You will wear the monitor at home for seven days. Parents or guardians will assist children 6-11 years old. You will be asked to return the monitor to our office in a prepaid envelope provided.

Persons who test positive for hepatitis C will be called to request participation in a brief phone interview six months after the exam. Parents will respond for children. Men with a high PSA test result will be called to request participation in a brief phone interview six months after the exam.

Taking part in these interviews and health exams after your visit to the exam center is voluntary.

How are NHANES data used?

What you tell us, your exam findings, and samples you give are a rich resource for health science. Many Federal agencies, universities, and other public and private groups use NHANES data. They use it to help find new cures and treatments for diseases and disabilities. The aim is to enhance the health of all people. Results of this survey may be reported in journals, at major meetings, or through other news media. None of these reports will ever name or use data that can point to any person who took part in the survey.

Many of the National Institutes of Health help us in this survey. The U.S. Department of Agriculture is our partner in planning how to get data on the foods you eat. We share with them the task of looking at people's diets in the United States.

The U.S. Environmental Protection Agency is another of our many partners. Your survey data helps study harmful effects of being exposed to environmental hazards.

Combining NHANES results with other facts about you can be useful. An example of this is using Social Security numbers to link survey data with vital statistics and other health records. Also, we may need to contact you in the future. To do this we would ask public or private agencies, such as the Post Office, to provide changes in your address.

In the past, we have had the chance to call or revisit people who took part in this survey. We may contact you in the future to ask you to be part of other research projects.

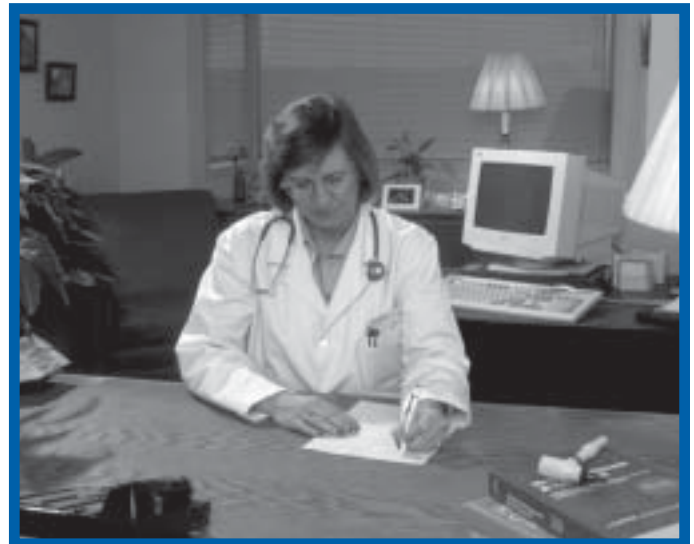

More questions?

Our survey representative can discuss other questions or concerns or give you other printed matter that can help. She or he can give you a phone number in your area that you can call for more facts about the survey. Also, you can make a free call to Dr. Kathryn Porter of the U.S. Public Health Service to discuss any aspect of the survey. She can be reached at 1-800-452-6115, Monday-Friday, 9 AM - 6 PM EST. You may also contact her regarding any survey-related injury. You can also get answers to your questions by mail (Room 4322, 3311 Toledo Rd., Hyattsville, MD 20782). If you have questions about your rights as a participant, call the Institutional Review Board Chairperson at 1-800-223-8118.

Mobile Examination Center (MEC) Diagram

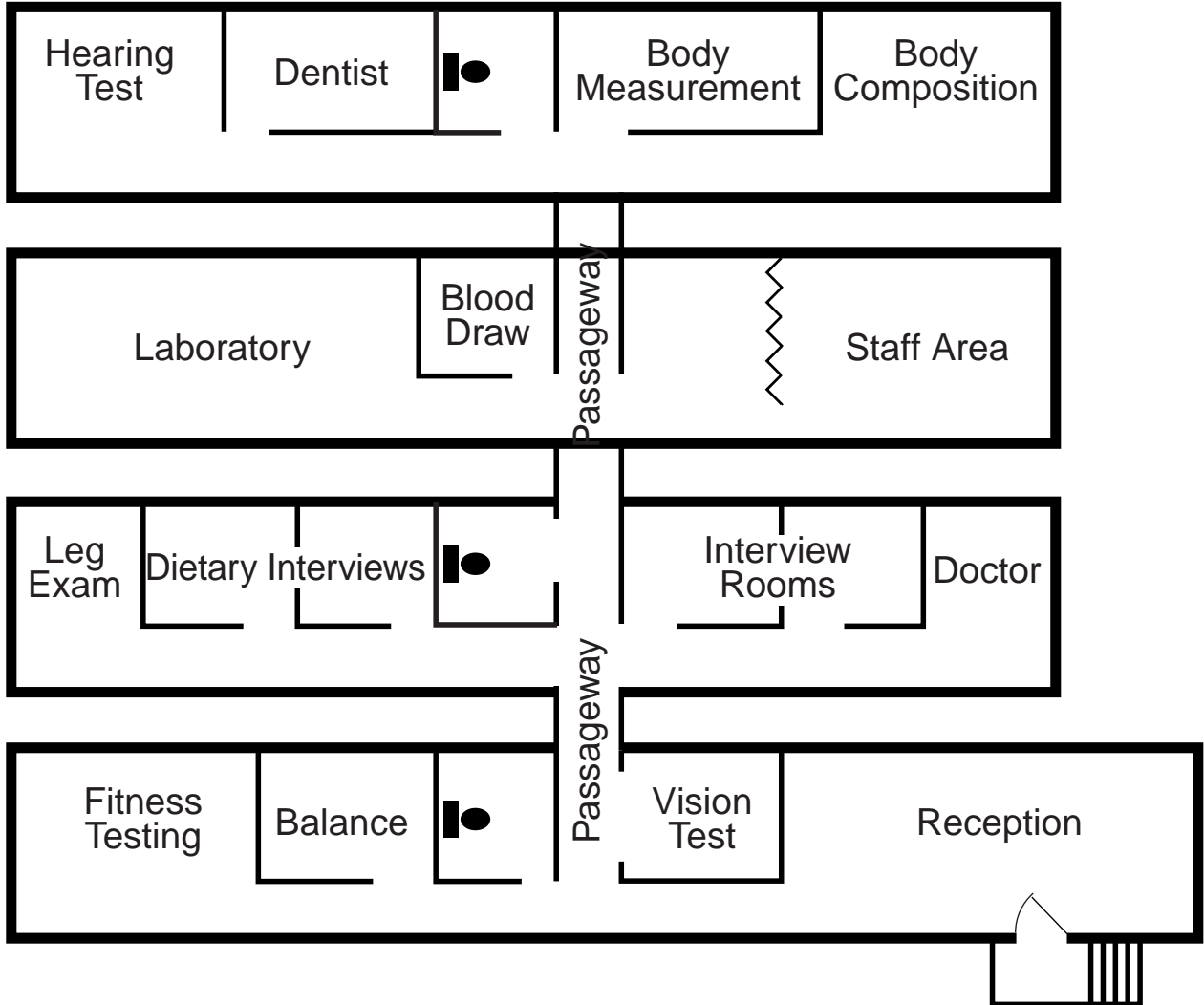

If you agree to take part in NHANES, we ask you to sign the attached consent form to show that you know the nature and purpose of the survey. Please be sure you understand the facts we have given you and that all questions are answered.

NATIONAL HEALTH AND NUTRITION EXAMINATION SURVEY
CONSENT/ASSENT AND PARENTAL PERMISSION FOR EXAMINATION AT THE MOBILE EXAMINATION CENTER

Print name of participant _____
First Middle Last

The attached brochure gives the details about National Health and Nutrition Examination Survey (NHANES). After reading the information provided, please complete the form below.

For the Parent or Guardian of the Survey Participant who is Under 18 Years Old: (unless the participant is an emancipated minor):

I have read the information in the attached NHANES brochure, which explains the nature and purpose of the survey. I freely choose to let my child take part in the survey.

Signature of parent/guardian of participant Date

If you **do not want a written report** of your child's exam results, check here .

For the Survey Participant who is 12 Years Old or Older:

I have read the information in the attached NHANES brochure, which explains the nature and purpose of the survey. I freely choose to take part in the survey.

Signature of participant Date

If you **do not want a written report** of your exam results, check here .

Signature of staff member Date Witness (if required) Date

SP ID

For more information about the National Center for Health Statistics contact:

Data Dissemination Branch
National Center for Health Statistics
3311 Toledo Road, Room 5407
Hyattsville, Maryland 20782

Telephone: (301) 458-INFO (4636)

E-mail: nchsquery@cdc.gov

Internet: www.cdc.gov/nchs

For more information about the National Health and Nutrition Examination Survey you may visit the NHANES web site at: www.cdc.gov/nhanes